

ELEVATIE CONSOLA CS ELEVATION CANTILEVER CS

Sc 1:10

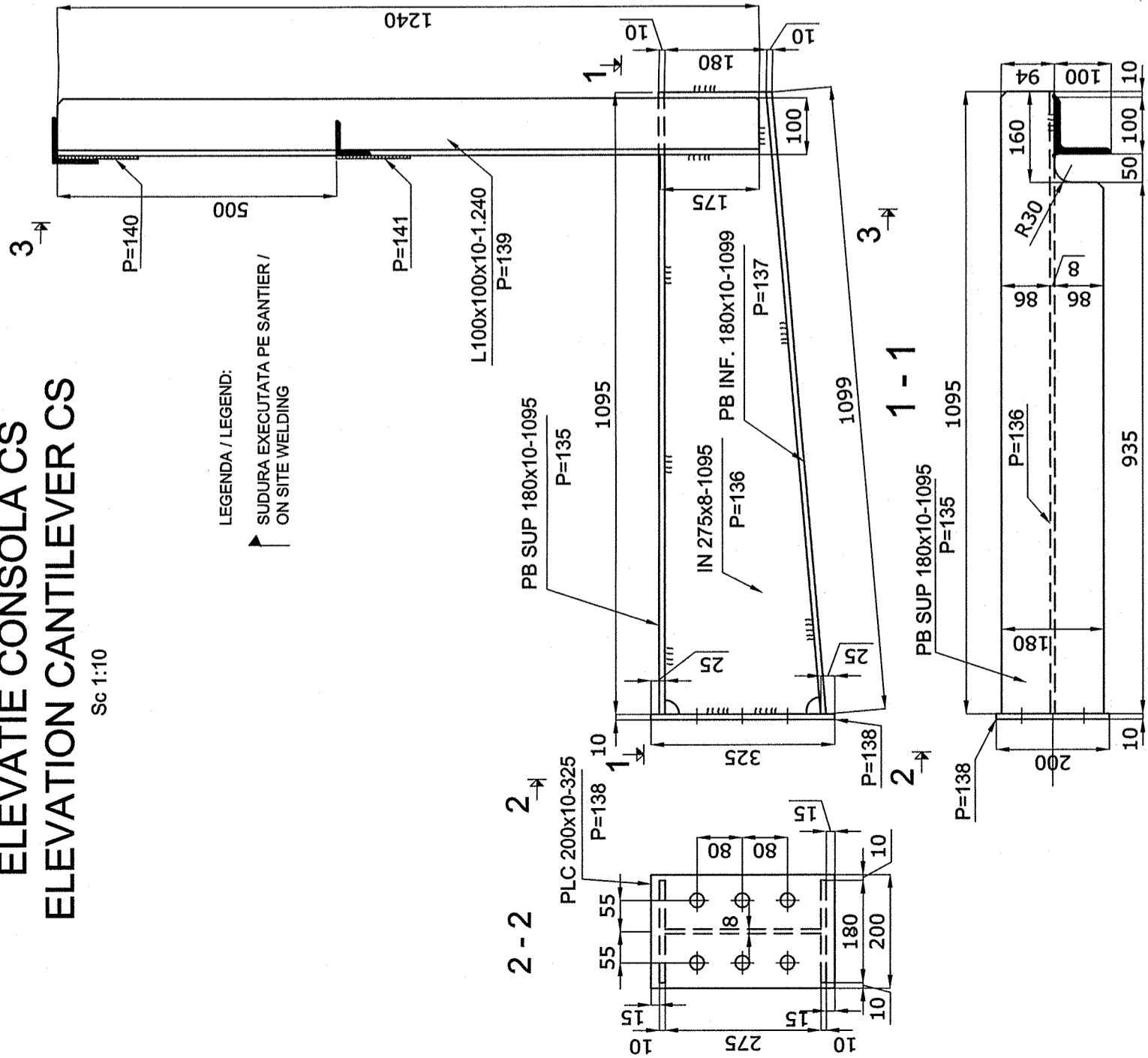

LEGENDA / LEGEND:
SUDURA EXECUTATA PE SANTIER /
ON SITE WELDING

DETALIU INIMA DETAIL WEB CS P=136

Sc 1:10

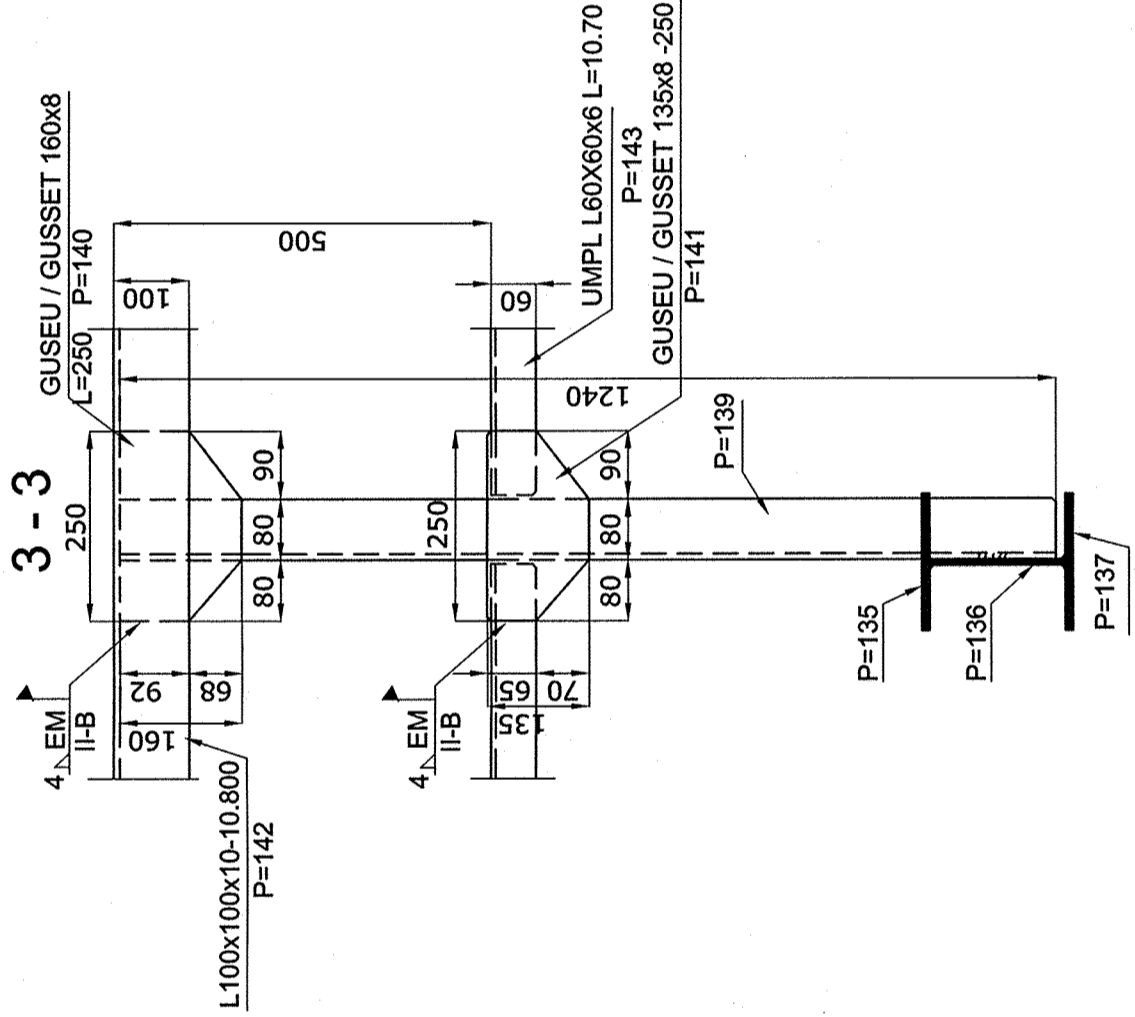
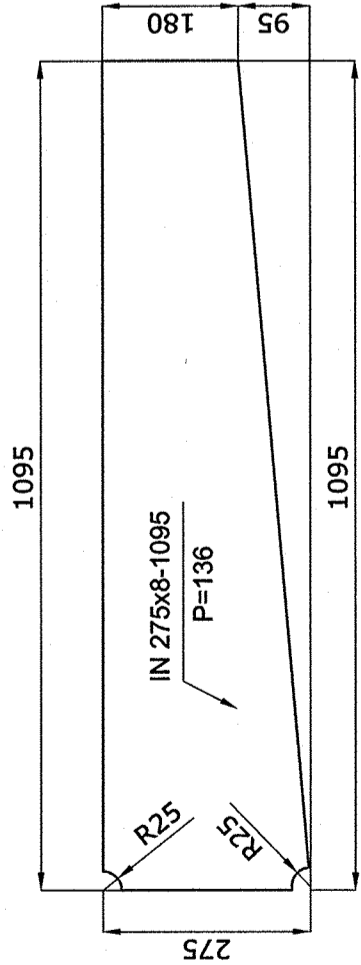

EVALUAREA MATERIALULUI METALIC PENTRU CONSOLELE CS SI PARAPET (PENTRU UN TABLIER) EVALUATION OF METALLIC MATERIALS FOR CANTILEVERS CS AND HANDRAIL (FOR 1 SUPERSTRUCTURE)

POZ	DENUMIRE PIESA	BUC	SECTIUNE	L[m]	Kg/m	Kg/buc	MASA OL37-2n	MASA OL-37-3k
135	PB SUP CONSOLA	62	180x10	1.095	14.13	15.47		960
136	IN CONSOLA	62	275x8	1.095	17.27	18.91		1172
137	PB INF CONSOLA	62	180x10	1.099	14.13	15.52		963
138	PLACA PRINDERE	62	200x10	0.325	15.70	5.10		316
139	STALP PARAPET	62	L100x100x10	1.240	15.00	18.60		1153
140	GUSEU MANA CRT	12	160x8	0.250	-	1.40		17
141	GUSEU UEMPL.	12	135x8	0.250	-	1.10		13
142	MANA CRT	12	L100x100x10	10.800	15.00	162.0		1944
143	UMPLUTURA.	12	L60x60x6	10.700	5.42	58.0		696
							TOTAL [Kg]	7235

SCHEMA GENERALA TABLIER / GENERAL SCHEME SUPERSTRUCTURE ELEVATIE / ELEVATION

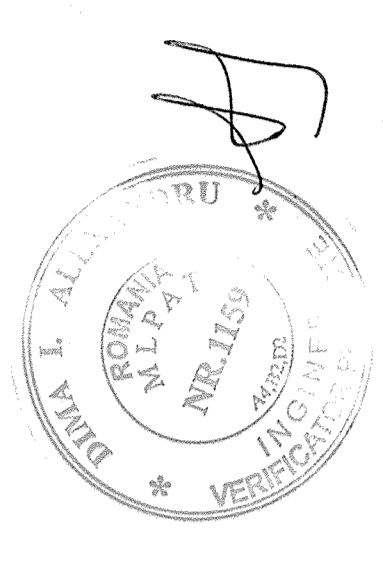
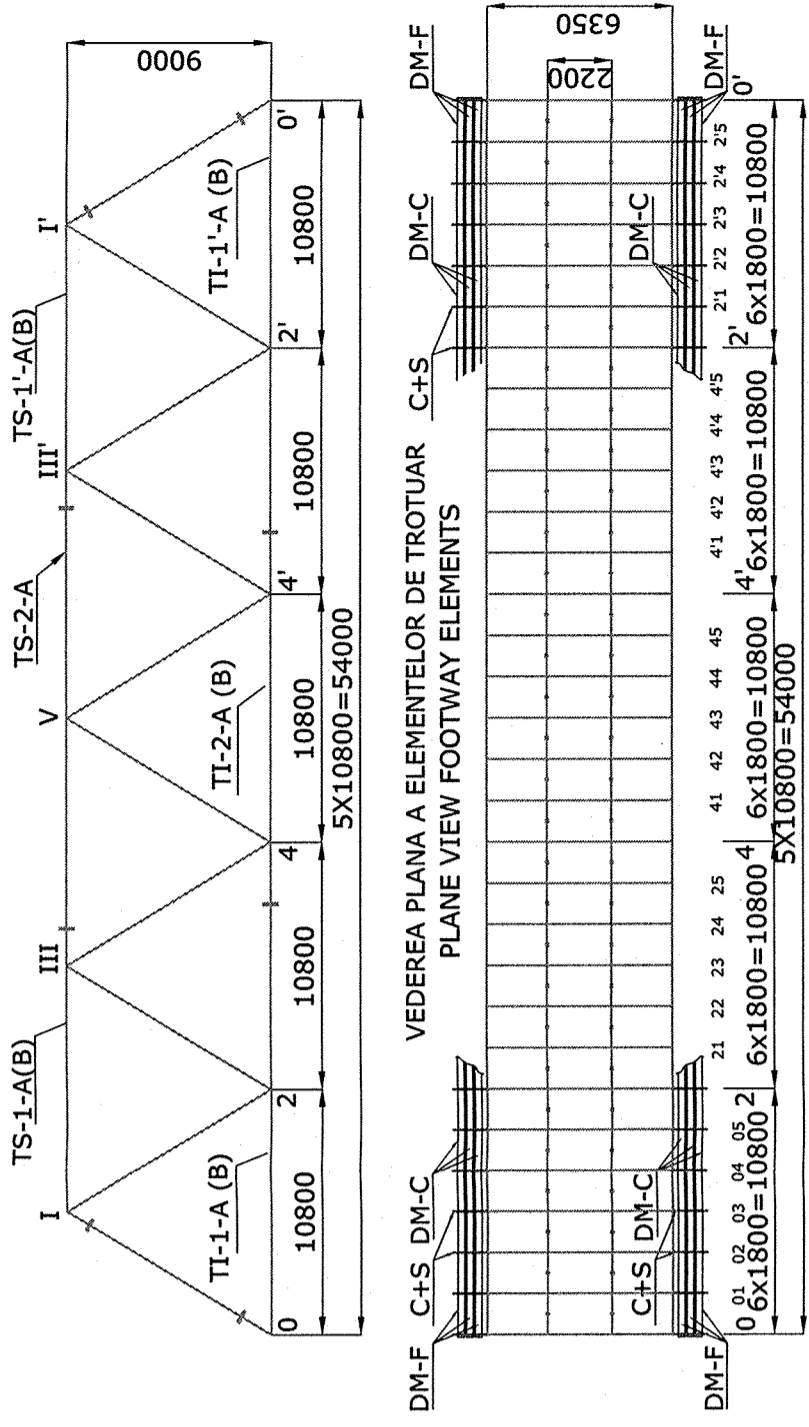

B						
A	Data / Date	Modificari / Revision				
BENEFICIAR / BENEFICIARY:			AUTORITATEA CONTRACTANTA / CONTRACTING AUTHORITY			 Contract / Contract: 1303/2007 Faza / Phase: PTH+DE TP+DD
ROMANIAN RAILWAY NATIONAL COMPANY			Ministerul Transporturilor / Ministry of Transport			
Ministerul Economiei si Finantelor / Ministry of Economy and Finance			Ministerul Transporturilor / Ministry of Transport			
Inocmit / Designed	Ing. Cristian Dima	Scara / Scale:	1:10	AUTORITATEA CONTRACTANTA / CONTRACTING AUTHORITY Ministerul Economiei si Finantelor / Ministry of Economy and Finance Ministerul Transporturilor / Ministry of Transport POS Transport 2007-2013		PORTOFOLIUL DE PROIECTE PHARE CES 2005 / PHARE CES 2005 PROJECTS PORTFOLIO LOT 1 Asistenta tehnica pentru pregatirea unor lucrari de reabilitare pentru tuneluri si poduri de cale ferata / Technical assistance for preparing rehabilitation works required by railway tunnels and bridges
Verificat / Checked	Ing. Ioan Dachtin	Data / Date:	05.2009	UNIUNEA EUROPEANA / EUROPEAN UNION Project financed by EUROPEAN UNION PORTOFOLIUL DE PROIECTE PHARE CES 2005 / PHARE CES 2005 PROJECTS PORTFOLIO LOT 1		
Sef echipa / Team leader	Ing. Stelian Vara-Oros			Denumire desen / Drawing Title: Pod / Bridge km 57+560 CONSOLELE DE TROTUAR CS SI DETALII PARAPET / SIDEWALK CANTILEVERS CS AND HANDRAIL DETAILS		
				Cod desen / Drawing Code: PD 21		